

YA	Articulated robots
LCM	Linear conveyor modules
CX	Single-axis robots
Robonity	Motor-less single axis actuator
TRANSEVO	Compact single-axis robots
FLIP-X	Single-axis robots
PHASER	Linear motor single-axis robots
XY-X	Cartesian robots
YK-X	SCARA robots
YP-X	Pick & place robots
CLEAN	CLEAN
CONTROLLER	CONTROLLER
INFORMATION	INFORMATION
Orbit/Extra small type	Orbit/Extra small type
Small / Medium type	Small / Medium type
Large type	Large type
Wall mount / Inverse type	Wall mount / Inverse type
Dust-proof & drip-proof type	Dust-proof & drip-proof type

YK350XGP Tool flange mount type

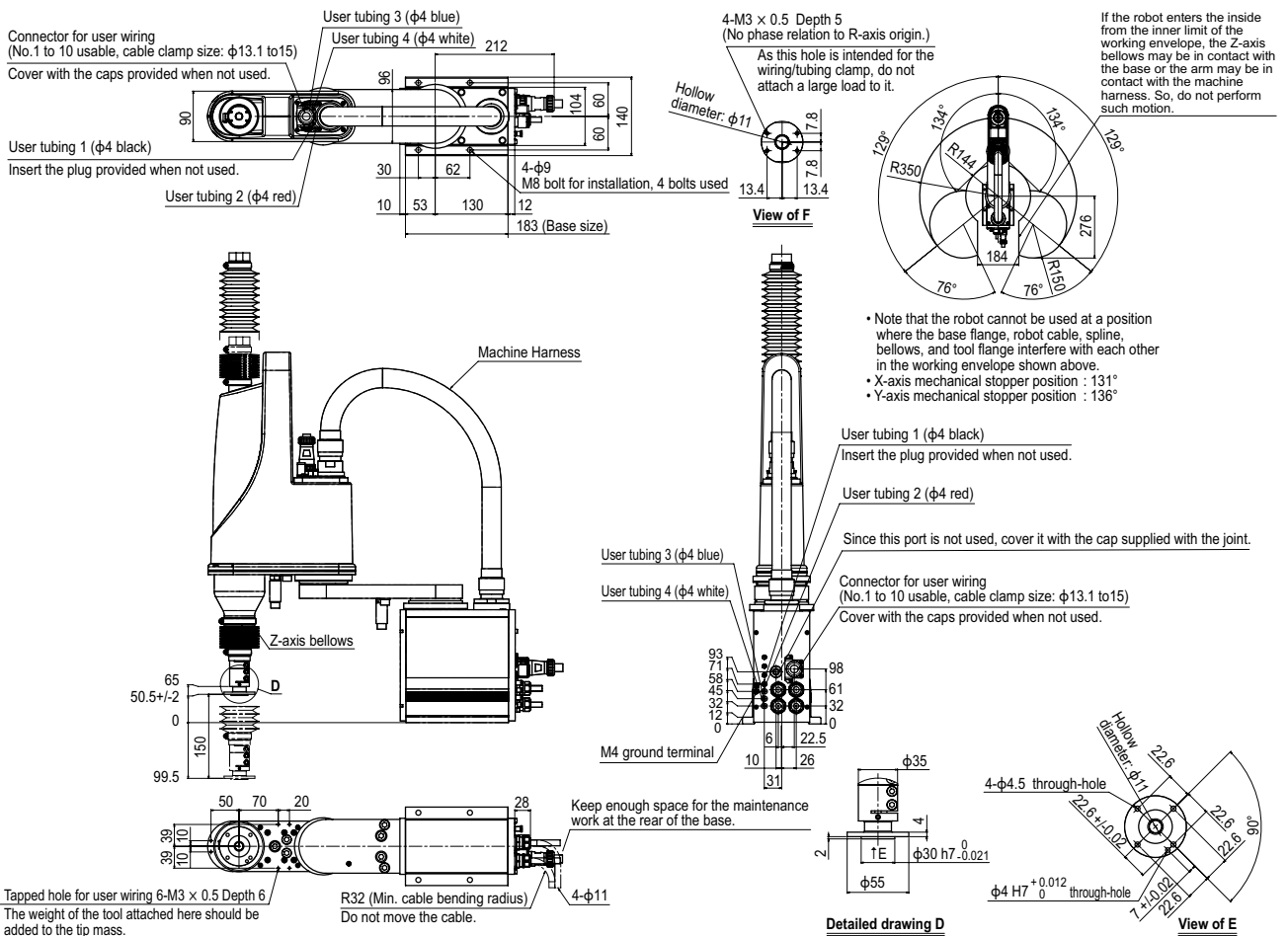

YA	Articulated robots
LCM	Linear conveyor modules
CX	Single-axis robots
Robonity	Motor-less single axis actuator
TRANSERO	Compact single-axis robots
FLIP-X	Single-axis robots
PHASER	Linear motor single-axis robots
XY-X	Cartesian robots
YK-X	SCARA robots
YP-X	Pick & place robots
CLEAN	CLEAN
CONTROLLER	CONTROLLER
INFORMATION	INFORMATION
Orbit/Extra small type	Orbit/Extra small type
Small / Medium type	Small / Medium type
Large type	Large type
Wall mount / Inverse type	Wall mount / Inverse type
Dust-proof & drip-proof type	Dust-proof & drip-proof type

YK400XGP Tool flange mount type

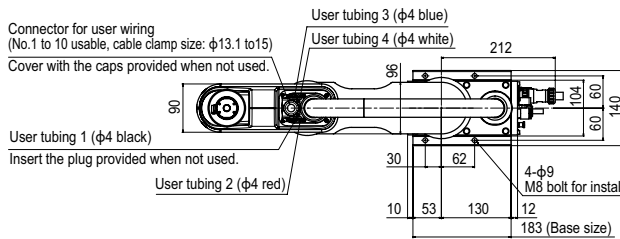

4-M3 x 0.5 Depth 5 (No phase relation to R-axis origin.)

As this hole is intended for the wiring/tubing clamp, do not attach a large load to it.

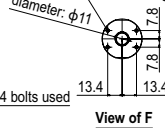

If the robot enters the inside from the inner limit of the working envelope, the Z-axis bellows may be in contact with the base or the arm may be in contact with the machine harness. So, do not perform such motion.

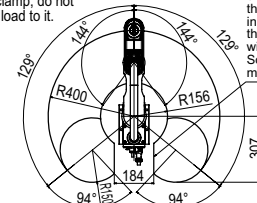

- Note that the robot cannot be used at a position where the base flange, robot cable, spline, bellows, and tool flange interfere with each other in the working envelope shown above.
- X-axis mechanical stopper position : 131°
- Y-axis mechanical stopper position : 146°

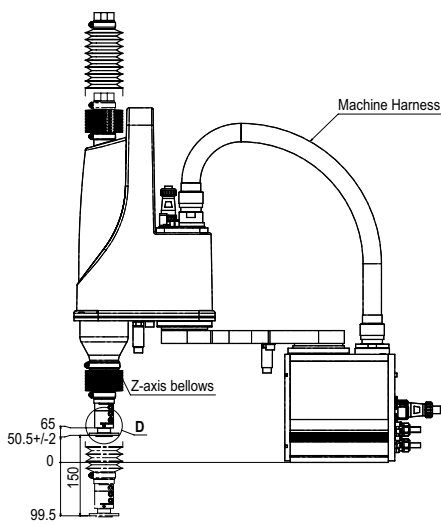

Tapped hole for user wiring 6-M3 x 0.5 Depth 6
The weight of the tool attached here should be added to the tip mass.

R32 (Min. cable bending radius)
Do not move the cable.

Keep enough space for the maintenance work at the rear of the base.

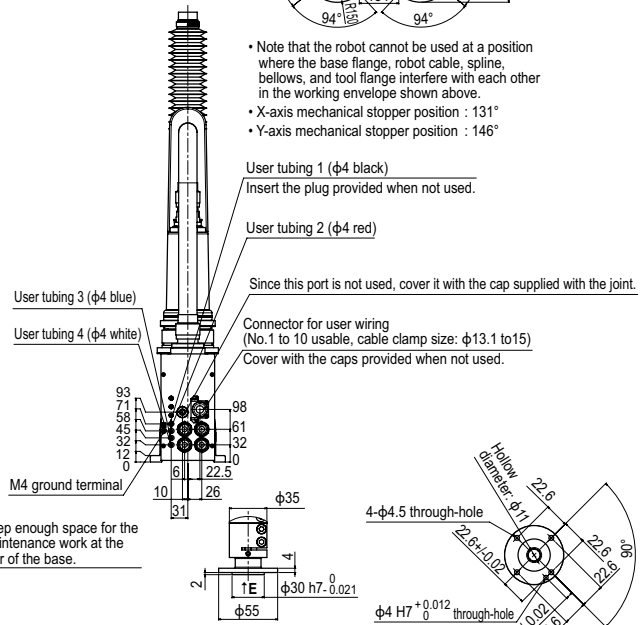

YA	Articulated robots
LCM	Linear conveyor modules
CX	Single-axis robots
Robonity	Motor-less single axis actuator
TRANSEVO	Compact single-axis robots
FLIP-X	Single-axis robots
PHASER	Linear motor single-axis robots
XY-X	Cartesian robots
YK-X	SCARA robots
YP-X	Pick & place robots
CLEAN	CLEAN
CONTROLLER	CONTROLLER
INFORMATION	INFORMATION
Orbit/Extra small type	Orbit/Extra small type
Small / Medium type	Small / Medium type
Large type	Large type
Wall mount / Inverse type	Wall mount / Inverse type
Dust-proof & drip-proof type	Dust-proof & drip-proof type

YK500XGLP Tool flange mount type

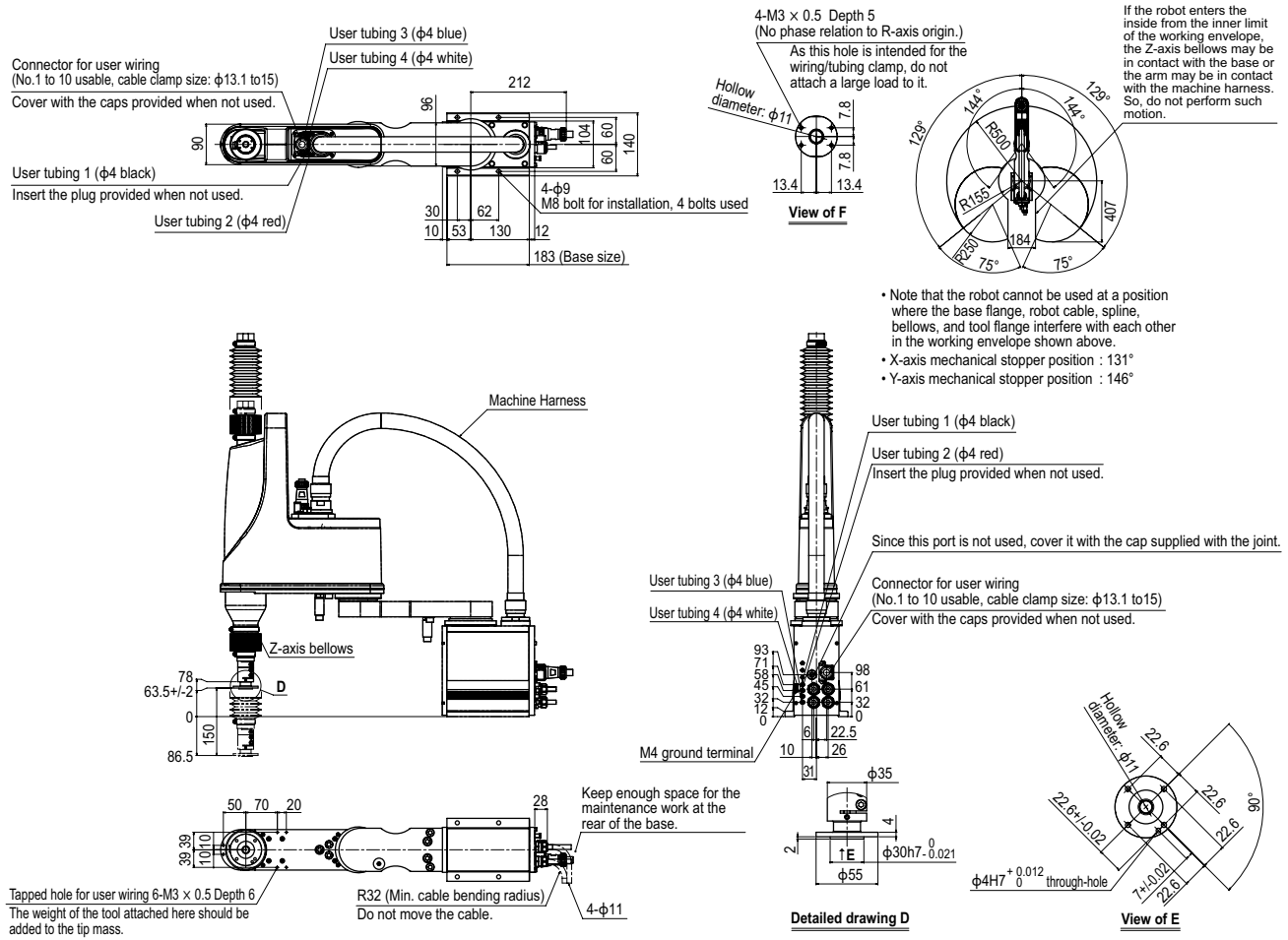

YK500XGP

Dust-proof & drip-proof type

- Arm length 500mm
- Maximum payload 10kg

Ordering method

YK500XGP		F		RCX340-4							
Model	Z axis stroke	Tool flange	Cable	Controller / Number of controllable axes	Safety standard	Option A (OP.A)	Option B (OP.B)	Option C (OP.C)	Option D (OP.D)	Option E (OP.E)	Absolute battery
	200: 200mm 300: 300mm	F: With tool flange	3L: 3.5m 5L: 5m 10L: 10m								

Specify various controller setting items. RCX340 ▶ **P.678**

Specifications

		X-axis	Y-axis	Z-axis	R-axis
Axis specifications	Arm length	200 mm	300 mm	200 mm / 300 mm	—
	Rotation angle	+/-130 °	+/-145 °	—	+/-360 °
AC servo motor output		400 W	200 W	200 W	200 W
Deceleration mechanism	Transmission method	Direct-coupled			
	Motor to speed reducer	Direct-coupled			
Repeatability <small>Note 1</small>		+/-0.01 mm		+/-0.01 mm	+/-0.004 °
	Maximum speed	7.6 m/sec		2.3 m/sec / 1.7 m/sec	1700 °/sec
Maximum payload		10 kg			
Standard cycle time: with 2kg payload <small>Note 2</small>		0.55 sec			
R-axis tolerable moment of inertia <small>Note 3</small>		0.3 kgm ²			
Protection class <small>Note 4</small>		Equivalent to IP65 (IEC 60529)			
User wiring		0.2 sq × 20 wires			
User tubing (Outer diameter)		φ 6 × 3			
Travel limit		1. Soft limit 2. Mechanical stopper (X,Y,Z axis)			
Robot cable length		Standard: 3.5 m Option: 5 m, 10 m			
Weight		Z axis 200 mm: 32 kg Z axis 300 mm: 33 kg			

Note 1. This is the value at a constant ambient temperature. (X,Y axes)

Note 2. When reciprocating 25mm in vertical direction and 300mm in horizontal direction (rough-positioning arch motion).

Note 3. The acceleration coefficient is set automatically in accordance with the tip weight and R-axis moment of inertia settings.

Note 4. Do not use robots where the bellows section is directly exposed to water jet. Contact our distributor for information on drip-proof structure preventing liquid other than water.

Controller

Controller	Power capacity (VA)	Operation method
RCX340	1700	Programming / I/O point trace / Remote command / Operation using RS-232C communication

Note. The movement range can be limited by changing the positions of X and Y axis mechanical stoppers. (The movement range is set to the standard at the time of shipment.) See our robot manuals (installation manuals) for detailed information.

Note. To set the standard coordinates with high accuracy, use a standard coordinate setting jig (option). Refer to the user's manual (installation manual) for more details.

Our robot manuals (installation manuals) can be downloaded from our website at the address below:
<https://global.yamaha-motor.com/business/robot/>

YK500XGP

Connector for user wiring (No.1 to 20 usable, cable clamp size: φ16 to 18)
Cover with the caps provided when not used.

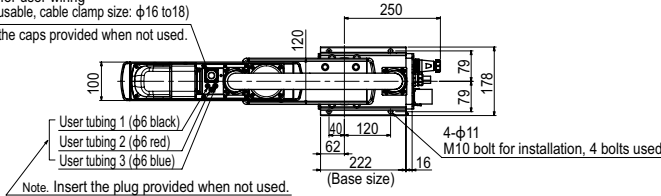

Note. Insert the plug provided when not used.

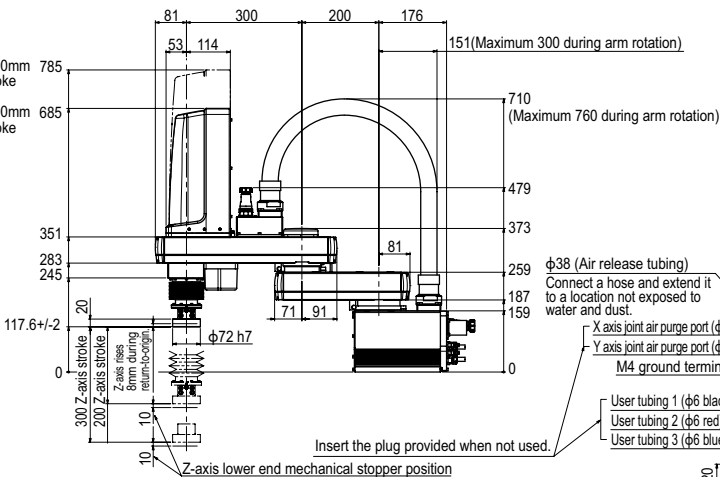

Insert the plug provided when not used.

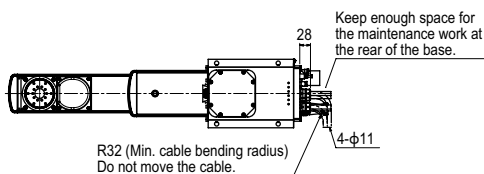

Keep enough space for the maintenance work at the rear of the base.

If the robot enters the inside of the corner of dimensions 135 and 292, the Z-axis tip flange may be in contact with the base or the arm may be in contact with the machine harness. So, do not perform such motion.

Working envelope of left-handed system

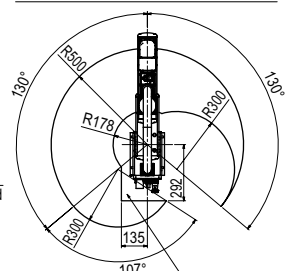

Working envelope of right-handed system

- Note that the robot cannot be used at a position where the base flange, robot cable, spline, and bellows interfere with each other in the working envelope shown above.
- X-axis mechanical stopper position : 132°
- Y-axis mechanical stopper position : 147°

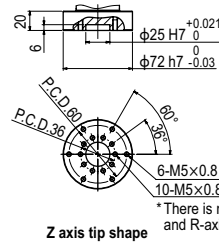

Z axis tip shape

* There is no phase relation between each position of M5 tapped holes and R-axis origin position.

YK600XGLP

Dust-proof & drip-proof type

- Arm length 600mm
- Maximum payload 4kg

Ordering method

YK600XGLP-150 **S** **RCX340-4**

Model	Z axis stroke	Tool flange	Hollow shaft	Cable	Controller / Number of controllable axes	Safety standard	Option A (OP.A)	Option B (OP.B)	Option C (OP.C)	Option D (OP.D)	Option E (OP.E)	Absolute battery
	150: 150mm	No entry: None F: With tool flange	S: With hollow shaft	3L: 3.5m 6L: 5m 10L: 10m								

Specify various axes controller setting items. RCX340 ▶ **P.678**

Specifications

		X-axis	Y-axis	Z-axis	R-axis
Axis specifications	Arm length	350 mm	250 mm	150 mm	-
	Rotation angle	+/-129 °	+/-144 °	-	+/-360 °
AC servo motor output		200 W	150 W	50 W	100 W
Deceleration mechanism	Transmission method	Direct-coupled			
	Motor to speed reducer Speed reducer to output	Direct-coupled			
Repeatability ^{Note 1}		+/-0.01 mm	+/-0.01 mm	+/-0.004 °	
Maximum speed		4.9 m/sec	1.1 m/sec	1020 °/sec	
Maximum payload		4 kg			
Standard cycle time: with 2kg payload ^{Note 2}		0.71 sec			
R-axis tolerable moment of inertia ^{Note 3}		0.05 kgm ²			
Protection class ^{Note 4}		Equivalent to IP65 (IEC 60529)			
User wiring (sq × wires)		0.2 × 10			
User tubing (Outer diameter)		φ 4 × 4			
Travel limit		1.Soft limit 2.Mechanical stopper (X,Y,Z axis)			
Robot cable length		Standard: 3.5 m Option: 5 m, 10 m			
Weight		26 kg			

- Note 1. This is the value at a constant ambient temperature. (X,Y axes)
 Note 2. When reciprocating 25mm in vertical direction and 300mm in horizontal direction (rough-positioning arch motion).
 Note 3. The acceleration coefficient is set automatically in accordance with the tip weight and R-axis moment of inertia settings.
 Note 4. Do not use robots where the bellows section is directly exposed to water jet. Contact our distributor for information on drip-proof structure preventing liquid other than water.

Controller

Controller	Power capacity (VA)	Operation method
RCX340	1000	Programming / I/O point trace / Remote command / Operation using RS-232C communication

- Note. The movement range can be limited by changing the positions of X and Y axis mechanical stoppers. (The movement range is set to the maximum at the time of shipment.)
 See our robot manuals (installation manuals) for detailed information.
 Note. To set the standard coordinates with high accuracy, use a standard coordinate setting jig (option). Refer to the user's manual (installation manual) for more details.

Our robot manuals (installation manuals) can be downloaded from our website at the address below:
<https://global.yamaha-motor.com/business/robot/>

YK600XGLP

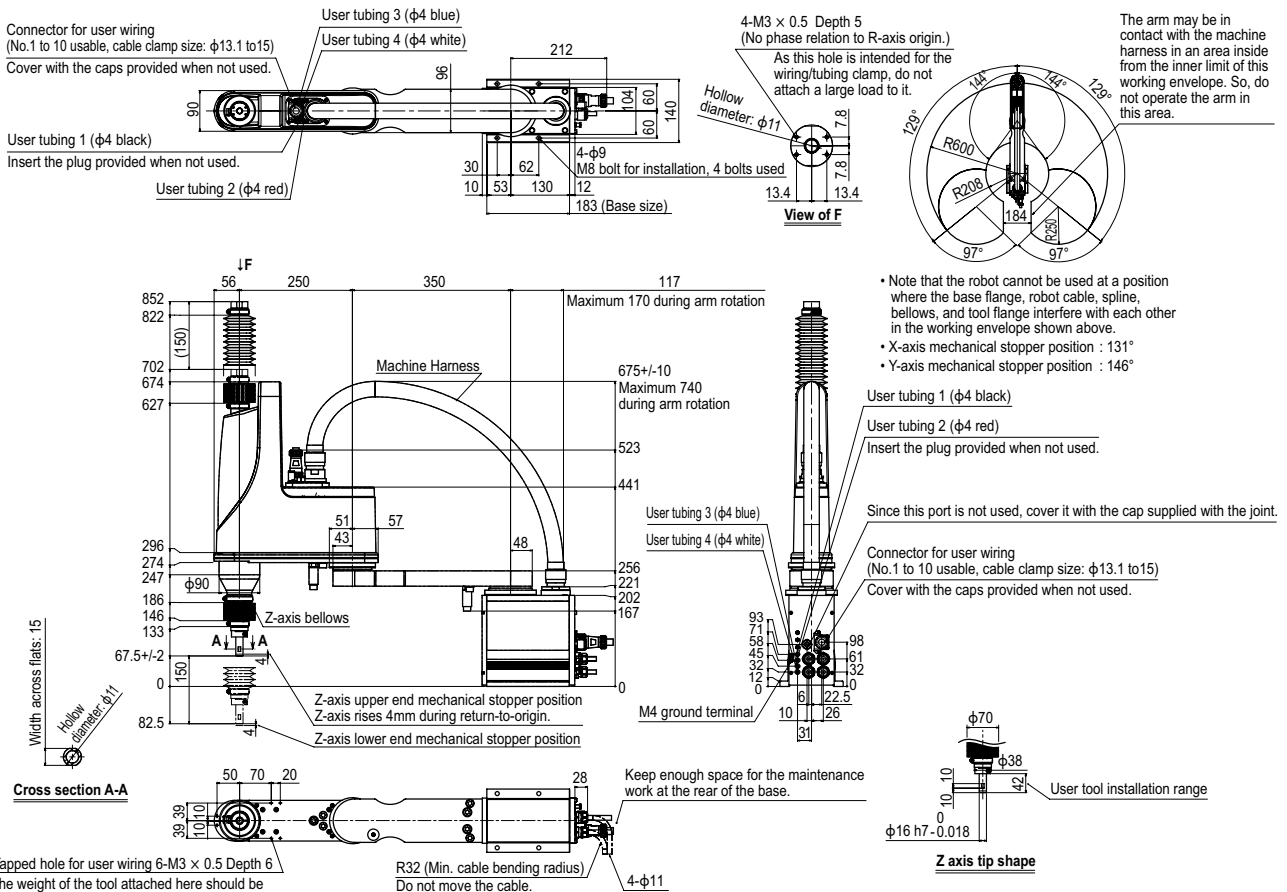

- Articulated robots YA
- Linear conveyor modules LCM
- Single-axis robots CX
- Motor-less single axis actuator Robonty
- Compact single-axis robots TRANSERO
- Single-axis robots FLIP-X
- Linear motor single-axis robots PHASER
- Cartesian robots XY-X
- SCARA robots YK-X
- Pick & place robots YP-X
- CLEAN
- CONTROLLER INFORMATION
- Ohbi/Extra small type
- Small / Medium type
- Large type
- Wall mount / Inverse type
- Dust-proof & drip-proof type

YK600XGLP Tool flange mount type

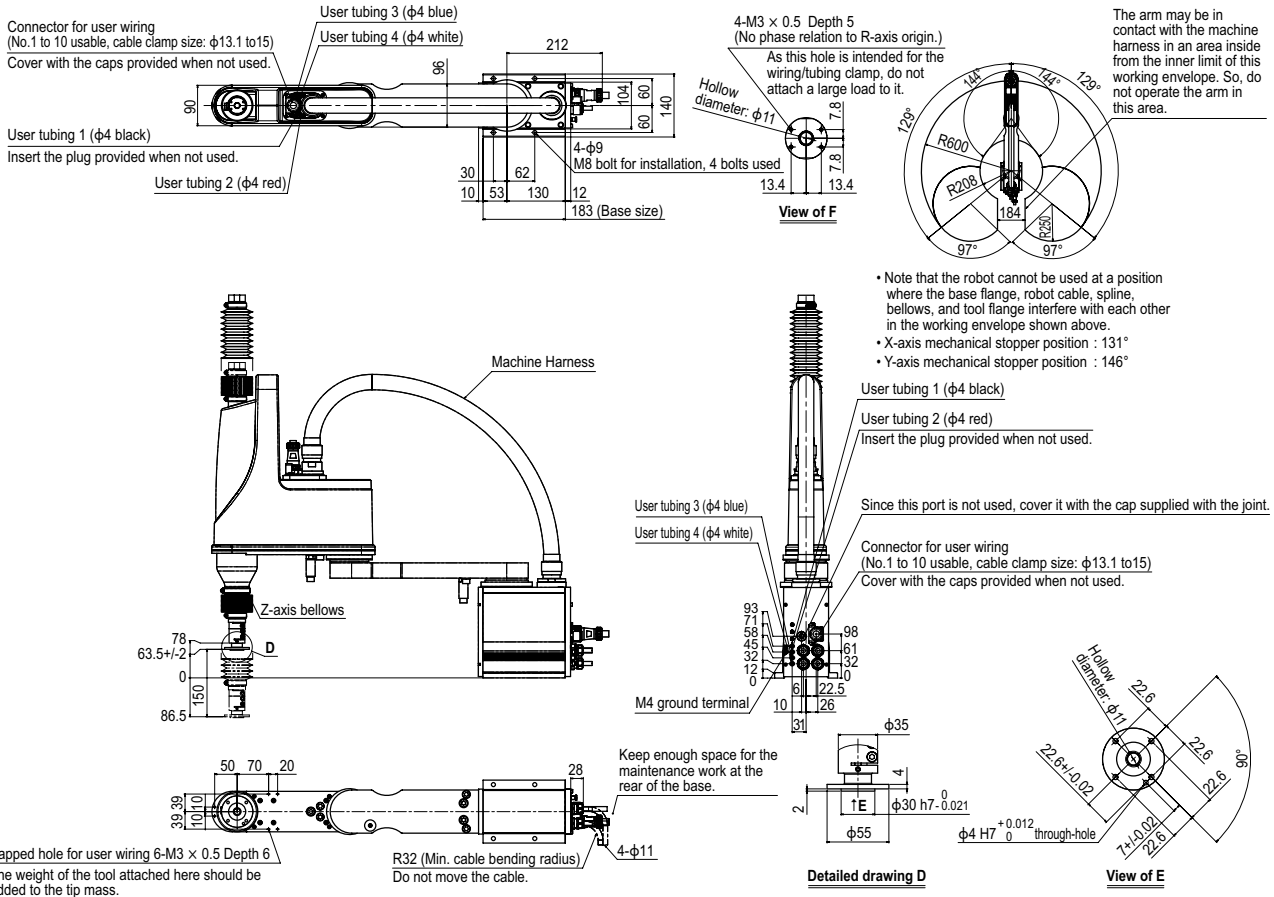

YK600XGP

Dust-proof & drip-proof type

- Arm length 600mm
- Maximum payload 10kg

Ordering method

YK600XGP		F		RCX340-4							
Model	Z axis stroke	Tool flange	Cable	Controller / Number of controllable axes	Safety standard	Option A (OP.A)	Option B (OP.B)	Option C (OP.C)	Option D (OP.D)	Option E (OP.E)	Absolute battery
	200: 200mm 300: 300mm	F: With tool flange	3L: 3.5m 5L: 5m 10L: 10m								

Specify various controller setting items. RCX340 ▶ **P.678**

Specifications

		X-axis	Y-axis	Z-axis	R-axis
Axis specifications	Arm length	300 mm	300 mm	200 mm 300 mm	—
	Rotation angle	+/-130 °	+/-145 °	—	+/-360 °
AC servo motor output		400 W	200 W	200 W	200 W
Deceleration mechanism	Transmission method	Direct-coupled			
	Motor to speed reducer Speed reducer to output	Direct-coupled			
Repeatability ^{Note 1}		+/-0.01 mm	+/-0.01 mm	+/-0.004 °	
Maximum speed		8.4 m/sec	2.3 m/sec 1.7 m/sec	1700 °/sec	
Maximum payload		10 kg			
Standard cycle time: with 2kg payload ^{Note 2}		0.56 sec			
R-axis tolerable moment of inertia ^{Note 3}		0.3 kgm ²			
Protection class ^{Note 4}		Equivalent to IP65 (IEC 60529)			
User wiring (sq × wires)		0.2 × 20			
User tubing (Outer diameter)		φ 6 × 3			
Travel limit		1.Soft limit 2.Mechanical stopper (X,Y,Z axis)			
Robot cable length		Standard: 3.5 m Option: 5 m, 10 m			
Weight		Z axis 200 mm: 33 kg Z axis 300 mm: 34 kg			

Note 1. This is the value at a constant ambient temperature. (X,Y axes)
 Note 2. When reciprocating 25mm in vertical direction and 300mm in horizontal direction (rough-positioning arch motion).
 Note 3. The acceleration coefficient is set automatically in accordance with the tip weight and R-axis moment of inertia settings.
 Note 4. Do not use robots where the bellows section is directly exposed to water jet. Contact our distributor for information on drip-proof structure preventing liquid other than water.

Controller

Controller	Power capacity (VA)	Operation method
RCX340	1700	Programming / I/O point trace / Remote command / Operation using RS-232C communication

Note. The movement range can be limited by changing the positions of X and Y axis mechanical stoppers. (The movement range is set to the maximum at the time of shipment.)
 See our robot manuals (installation manuals) for detailed information.
 Note. To set the standard coordinates with high accuracy, use a standard coordinate setting jig (option). Refer to the user's manual (installation manual) for more details.

Our robot manuals (installation manuals) can be downloaded from our website at the address below:
<https://global.yamaha-motor.com/business/robot/>

YK600XGP

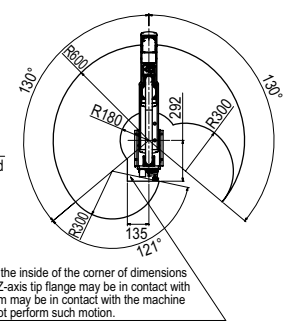
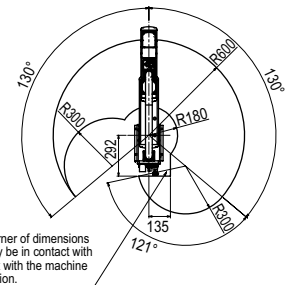
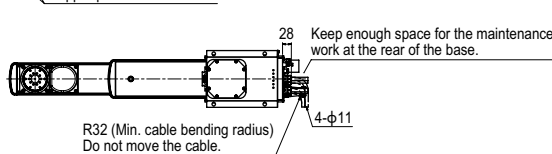
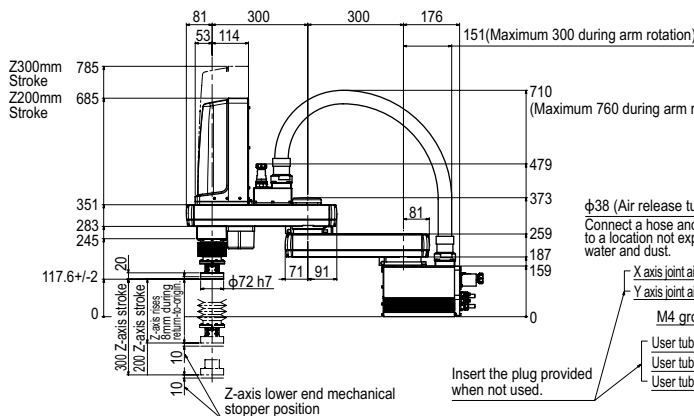
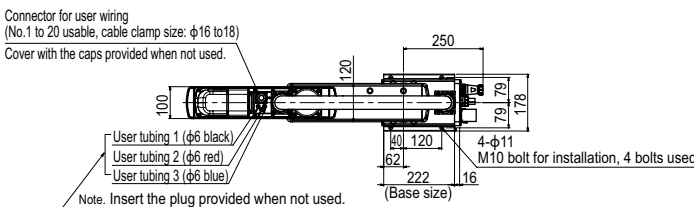

• Note that the robot cannot be used at a position where the base flange, robot cable, spline, and bellows interfere with each other in the working envelope shown above.
 • X-axis mechanical stopper position : 132°
 • Y-axis mechanical stopper position : 147°

• There is no phase relation between each position of M5 tapped holes and R-axis origin position.

YK600XGHP

Dust-proof & drip-proof type

- Arm length 600mm
- Maximum payload 18kg

Ordering method

YK600XGHP		F		RCX340-4							
Model	Z axis stroke	Tool flange	Cable	Controller / Number of controllable axes	Safety standard	Option A (OP.A)	Option B (OP.B)	Option C (OP.C)	Option D (OP.D)	Option E (OP.E)	Absolute battery
	200: 200mm 400: 400mm	F: With tool flange	3L: 3.5m 5L: 5m 10L: 10m								

Specify various controller setting items. RCX340 ▶ **P.678**

Specifications

		X-axis	Y-axis	Z-axis	R-axis
Axis specifications	Arm length	200 mm	400 mm	200 mm	400 mm
	Rotation angle	+/-130 °	+/-150 °	-	+/-360 °
AC servo motor output		750 W	400 W	400 W	200 W
Deceleration mechanism	Transmission method	Direct-coupled			
	Motor to speed reducer	Direct-coupled			
Repeatability <small>Note 1</small>	Speed reducer to output	Direct-coupled			
		+/-0.02 mm	+/-0.01 mm	+/-0.004 °	
Maximum speed		7.7 m/sec	2.3 m/sec	1.7 m/sec	920 °/sec
Maximum payload		18 kg			
Standard cycle time: with 2kg payload <small>Note 2</small>		0.57 sec			
R-axis tolerable moment of inertia <small>Note 3</small>		1.0 kgm ²			
Protection class <small>Note 4</small>		Equivalent to IP65 (IEC 60529)			
User wiring (sq × wires)		0.2 × 20			
User tubing (Outer diameter)		φ 6 × 3			
Travel limit		1. Soft limit 2. Mechanical stopper (X,Y,Z axis)			
Robot cable length		Standard: 3.5 m Option: 5 m, 10 m			
Weight		Z axis 200 mm: 52 kg Z axis 400 mm: 54 kg			

Note 1. This is the value at a constant ambient temperature. (X,Y axes)
 Note 2. When reciprocating 25mm in vertical direction and 300mm in horizontal direction (rough-positioning arch motion).
 Note 3. The acceleration coefficient is set automatically in accordance with the tip weight and R-axis moment of inertia settings.
 Note 4. Do not use robots where the bellows section is directly exposed to water jet. Contact our distributor for information on drip-proof structure preventing liquid other than water.

Controller

Controller	Power capacity (VA)	Operation method
RCX340	2500	Programming / I/O point trace / Remote command / Operation using RS-232C communication

Note. The movement range can be limited by changing the positions of X and Y axis mechanical stoppers. (The movement range is set to the maximum at the time of shipment.)
 See our robot manuals (installation manuals) for detailed information.

Note. To set the standard coordinates with high accuracy, use a standard coordinate setting jig (option). Refer to the user's manual (installation manual) for more details.

Our robot manuals (installation manuals) can be downloaded from our website at the address below:
<https://global.yamaha-motor.com/business/robot/>

YK600XGHP

Connector for user wiring (No.1 to 20 usable, cable clamp size: φ16 to 18)
 Cover with the caps provided when not used.

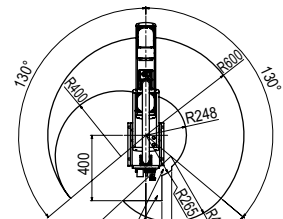
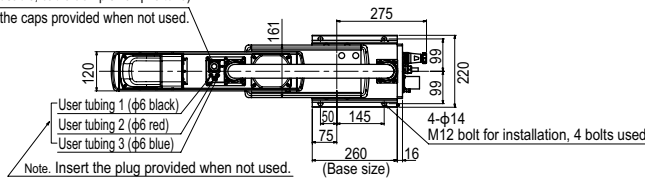

Working envelope of left-handed system

If the robot enters the inside of R265 and corner of dimensions 98 and 400, the Z-axis tip flange may be in contact with the base or the arm may be in contact with the machine harness. So, do not perform such motion.

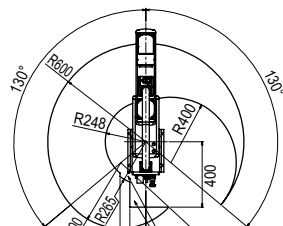
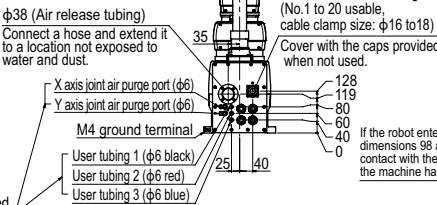
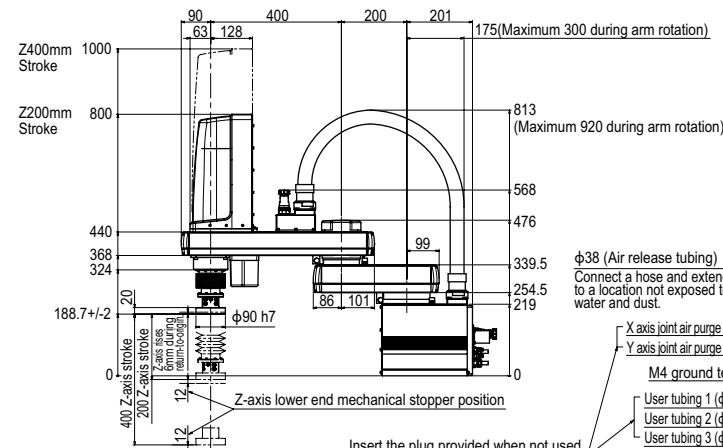

Working envelope of right-handed system

- Note that the robot cannot be used at a position where the base flange, robot cable, spline, and bellows interfere with each other in the working envelope shown above.
- X-axis mechanical stopper position : 132°
- Y-axis mechanical stopper position : 152°

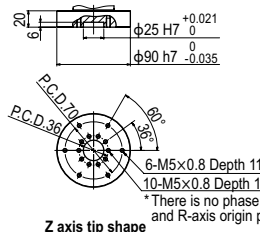
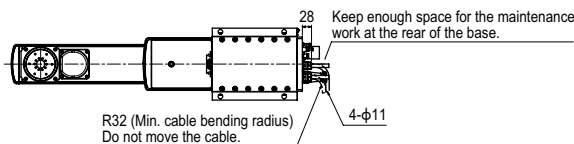

Z axis tip shape

YK700XGP

Dust-proof & drip-proof type



- Arm length 700mm
- Maximum payload 20kg

Ordering method

YK700XGP		F		RCX340-4							
Model	Z axis stroke	Tool flange	Cable	Controller / Number of controllable axes	Safety standard	Option A (OP.A)	Option B (OP.B)	Option C (OP.C)	Option D (OP.D)	Option E (OP.E)	Absolute battery
	200: 200mm 400: 400mm	F: With tool flange	3L: 3.5m 5L: 5m 10L: 10m								

Specify various controller setting items. RCX340 ▶ **P.678**

Specifications

		X-axis	Y-axis	Z-axis	R-axis
Axis specifications	Arm length	300 mm	400 mm	200 mm	400 mm
	Rotation angle	+/-130 °	+/-150 °	-	+/-360 °
AC servo motor output		750 W	400 W	400 W	200 W
Deceleration mechanism	Transmission method	Direct-coupled			
	Motor to speed reducer Speed reducer to output	Direct-coupled			
Repeatability ^{Note 1}		+/-0.02 mm	+/-0.01 mm	+/-0.004 °	
Maximum speed		8.4 m/sec	2.3 m/sec	1.7 m/sec	920 °/sec
Maximum payload		20 kg			
Standard cycle time: with 2kg payload ^{Note 2}		0.52 sec			
R-axis tolerable moment of inertia ^{Note 3}		1.0 kgm ²			
Protection class ^{Note 4}		Equivalent to IP65 (IEC 60529)			
User wiring		0.2 sq × 20 wires			
User tubing (Outer diameter)		φ 6 × 3			
Travel limit		1.Soft limit 2.Mechanical stopper (X,Y,Z axis)			
Robot cable length		Standard: 3.5 m Option: 5 m, 10 m			
Weight		Z axis 200 mm: 54 kg Z axis 400 mm: 56 kg			

Note 1. This is the value at a constant ambient temperature. (X,Y axes)
 Note 2. When reciprocating 25mm in vertical direction and 300mm in horizontal direction (rough-positioning arch motion).
 Note 3. The acceleration coefficient is set automatically in accordance with the tip weight and R-axis moment of inertia settings.
 Note 4. Do not use robots where the bellows section is directly exposed to water jet. Contact our distributor for information on drip-proof structure preventing liquid other than water.

Controller

Controller	Power capacity (VA)	Operation method
RCX340	2500	Programming / I/O point trace / Remote command / Operation using RS-232C communication

Note. The movement range can be limited by changing the positions of X and Y axis mechanical stoppers. (The movement range is set to the maximum at the time of shipment.) See our robot manuals (installation manuals) for detailed information.
 Note. To set the standard coordinates with high accuracy, use a standard coordinate setting jig (option). Refer to the user's manual (installation manual) for more details.

Our robot manuals (installation manuals) can be downloaded from our website at the address below:
<https://global.yamaha-motor.com/business/robot/>

YK700XGP

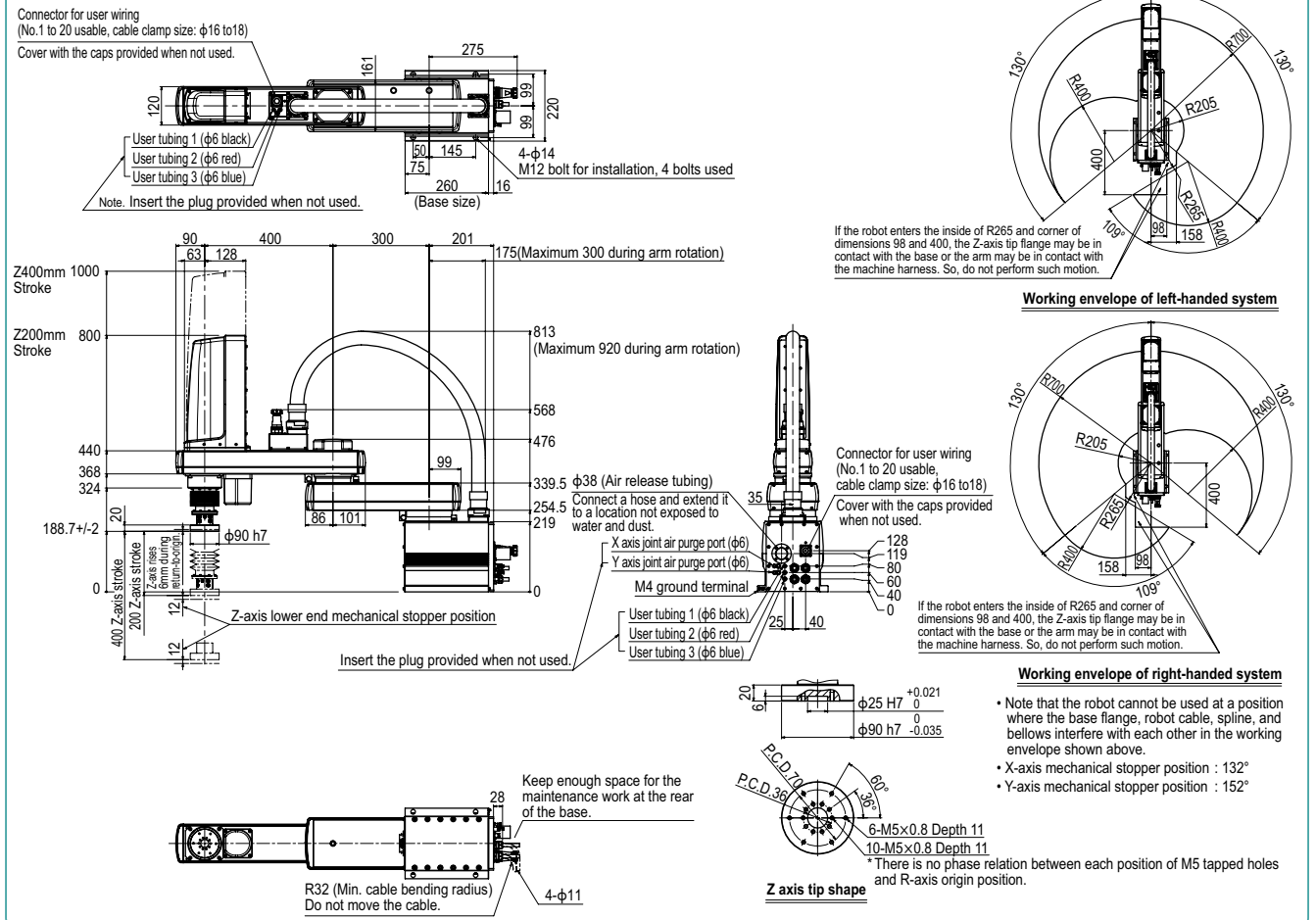

YK800XGP

Dust-proof & drip-proof type

- Arm length 800mm
- Maximum payload 20kg

Ordering method

YK800XGP		F		RCX340-4								
Model	Z axis stroke	Tool flange	Cable	Controller / Number of controllable axes	Safety standard	Option A (OP.A)	Option B (OP.B)	Option C (OP.C)	Option D (OP.D)	Option E (OP.E)	Absolute battery	
	200: 200mm 400: 400mm	F: With tool flange	3L: 3.5m 5L: 5m 10L: 10m									

Specify various controller setting items. RCX340 ▶ **P.678**

Specifications

		X-axis	Y-axis	Z-axis	R-axis
Axis specifications	Arm length	400 mm	400 mm	200 mm / 400 mm	—
	Rotation angle	+/-130 °	+/-150 °	—	+/-360 °
AC servo motor output		750 W	400 W	400 W	200 W
Deceleration mechanism	Transmission method	Direct-coupled			
	Motor to speed reducer	Direct-coupled			
Repeatability ^{Note 1}		+/-0.02 mm	+/-0.01 mm	+/-0.004 °	
	Maximum speed	9.2 m/sec	2.3 m/sec	1.7 m/sec	920 °/sec
Maximum payload		20 kg			
Standard cycle time: with 2kg payload ^{Note 2}		0.58 sec			
R-axis tolerable moment of inertia ^{Note 3}		1.0 kgm ²			
Protection class ^{Note 4}		Equivalent to IP65 (IEC 60529)			
User wiring		0.2 sq x 20 wires			
User tubing (Outer diameter)		φ 6 x 3			
Travel limit		1. Soft limit 2. Mechanical stopper (X,Y,Z axis)			
Robot cable length		Standard: 3.5 m Option: 5 m, 10 m			
Weight		Z axis 200 mm: 56 kg Z axis 400 mm: 58 kg			

Note 1. This is the value at a constant ambient temperature. (X,Y axes)
 Note 2. When reciprocating 25mm in vertical direction and 300mm in horizontal direction (rough-positioning arch motion).
 Note 3. The acceleration coefficient is set automatically in accordance with the tip weight and R-axis moment of inertia settings.
 Note 4. Do not use robots where the bellows section is directly exposed to water jet. Contact our distributor for information on drip-proof structure preventing liquid other than water.

Controller

Controller	Power capacity (VA)	Operation method
RCX340	2500	Programming / I/O point trace / Remote command / Operation using RS-232C communication

Note. The movement range can be limited by changing the positions of X and Y axis mechanical stoppers. (The movement range is set to the maximum at the time of shipment.)
 See our robot manuals (installation manuals) for detailed information.

Note. To set the standard coordinates with high accuracy, use a standard coordinate setting jig (option). Refer to the user's manual (installation manual) for more details.

Our robot manuals (installation manuals) can be downloaded from our website at the address below:
<https://global.yamaha-motor.com/business/robot/>

YK800XGP

Connector for user wiring (No.1 to 20 usable, cable clamp size: φ16 to 18)
 Cover with the caps provided when not used.

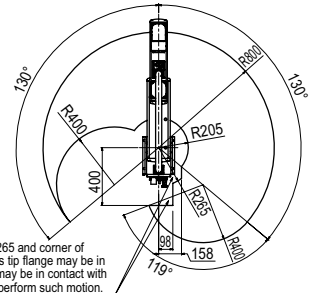
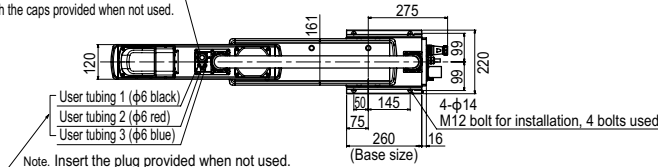

If the robot enters the inside of R265 and corner of dimensions 98 and 400, the Z-axis tip flange may be in contact with the base or the arm may be in contact with the machine harness. So, do not perform such motion.

Working envelope of left-handed system

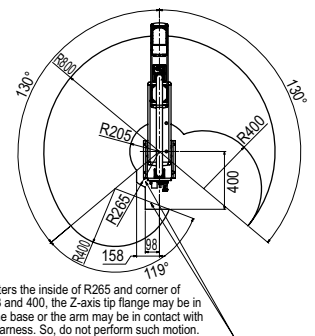

If the robot enters the inside of R265 and corner of dimensions 98 and 400, the Z-axis tip flange may be in contact with the base or the arm may be in contact with the machine harness. So, do not perform such motion.

Working envelope of right-handed system

- Note that the robot cannot be used at a position where the base flange, robot cable, spline, and bellows interfere with each other in the working envelope shown above.
- X-axis mechanical stopper position : 132°
- Y-axis mechanical stopper position : 152°

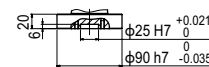
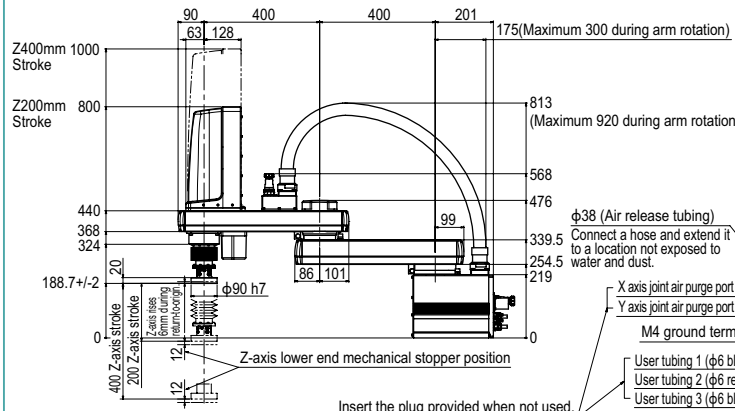

YK1000XGP

Dust-proof & drip-proof type

- Arm length 1000mm
- Maximum payload 20kg

Ordering method

YK1000XGP		F		RCX340-4							
Model	Z axis stroke	Tool flange	Cable	Controller / Number of controllable axes	Safety standard	Option A (OP.A)	Option B (OP.B)	Option C (OP.C)	Option D (OP.D)	Option E (OP.E)	Absolute battery
	200: 200mm 400: 400mm	F: With tool flange	3L: 3.5m 5L: 5m 10L: 10m								

Specify various controller setting items. RCX340 ▶ **P.678**

Specifications

Axis specifications	Arm length	X-axis	Y-axis	Z-axis	R-axis
	Rotation angle	600 mm	400 mm	200 mm 400 mm	—
		+/-130 °	+/-150 °	—	+/-360 °
	AC servo motor output	750 W	400 W	400 W	200 W
Deceleration mechanism	Transmission method	Direct-coupled			
	Motor to speed reducer	Direct-coupled			
	Speed reducer to output	Direct-coupled			
Repeatability ^{Note 1}		+/-0.02 mm		+/-0.01 mm	+/-0.004 °
Maximum speed		10.6 m/sec		2.3 m/sec 1.7 m/sec	920 °/sec
Maximum payload		20 kg			
Standard cycle time: with 2kg payload ^{Note 2}		0.59 sec			
R-axis tolerable moment of inertia ^{Note 3}		1.0 kgm ²			
Protection class ^{Note 4}		Equivalent to IP65 (IEC 60529)			
User wiring (sq × wires)		0.2 × 20			
User tubing (Outer diameter)		φ 6 × 3			
Travel limit		1.Soft limit 2.Mechanical stopper (X,Y,Z axis)			
Robot cable length		Standard: 3.5 m Option: 5 m, 10 m			
Weight		Z axis 200 mm: 60 kg Z axis 400 mm: 62 kg			

Note 1. This is the value at a constant ambient temperature. (X,Y axes)
 Note 2. When reciprocating 25mm in vertical direction and 300mm in horizontal direction (rough-positioning arch motion).
 Note 3. The acceleration coefficient is set automatically in accordance with the tip weight and R-axis moment of inertia settings.
 Note 4. Do not use robots where the bellows section is directly exposed to water jet. Contact our distributor for information on drip-proof structure preventing liquid other than water.

Controller

Controller	Power capacity (VA)	Operation method
RCX340	2500	Programming / I/O point trace / Remote command / Operation using RS-232C communication

Note. The movement range can be limited by changing the positions of X and Y axis mechanical stoppers. (The movement range is set to the maximum at the time of shipment.)
 See our robot manuals (installation manuals) for detailed information.

Note. To set the standard coordinates with high accuracy, use a standard coordinate setting jig (option). Refer to the user's manual (installation manual) for more details.

Our robot manuals (installation manuals) can be downloaded from our website at the address below:
<https://global.yamaha-motor.com/business/robot/>

YK1000XGP

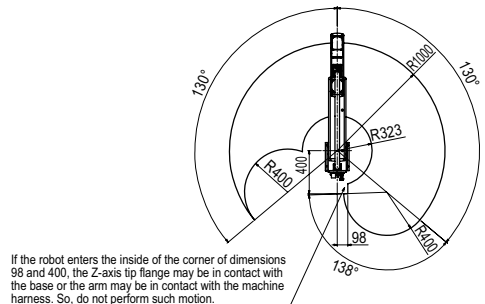
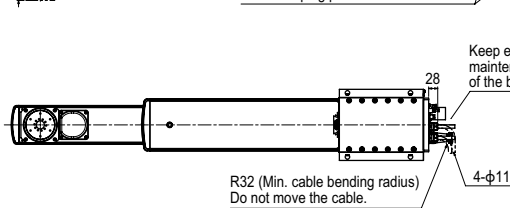
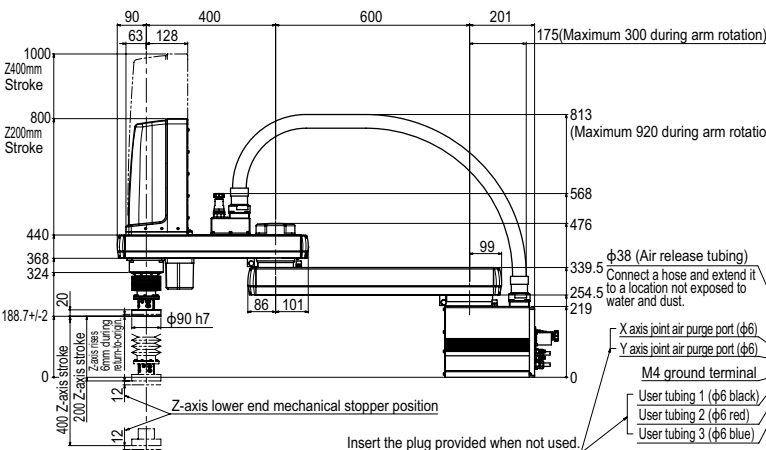
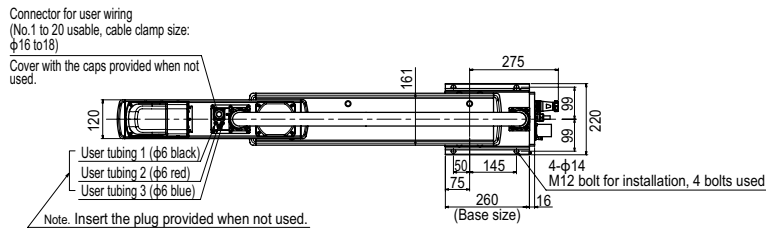

Working envelope of left-handed system

If the robot enters the inside of the corner of dimensions 98 and 400, the Z-axis tip flange may be in contact with the base or the arm may be in contact with the machine harness. So, do not perform such motion.

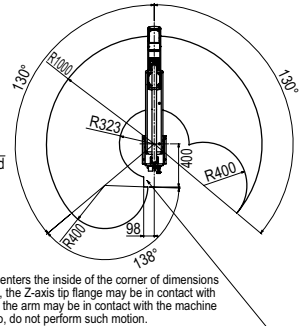

Working envelope of right-handed system

- Note that the robot cannot be used at a position where the base flange, robot cable, spline, and bellows interfere with each other in the working envelope shown above.
- X-axis mechanical stopper position : 132°
- Y-axis mechanical stopper position : 152°

YK250XGP

Dust-proof & drip-proof type



- Arm length 250mm
- Maximum payload 4kg

Ordering method

YK250XGP - 150 **S** **RCX340-4**

Model	Z axis stroke	Tool flange	Hollow shaft	Cable	Controller / Number of controllable axes	Safety standard	Option A (OP.A)	Option B (OP.B)	Option C (OP.C)	Option D (OP.D)	Option E (OP.E)	Absolute battery
	150: 150mm	No entry: None F: With tool flange	S: With hollow shaft	3L: 3.5m 5L: 5m 10L: 10m								

Specify various controller setting items. RCX340 ▶ **P.678**

Specifications

		X-axis	Y-axis	Z-axis	R-axis
Axis specifications	Arm length	100 mm	150 mm	150 mm	-
	Rotation angle	+/-129 °	+/-134 °	-	+/-360 °
AC servo motor output		200 W	150 W	50 W	100 W
Deceleration mechanism	Transmission method	Direct-coupled			
	Motor to speed reducer Speed reducer to output	Direct-coupled			
Repeatability ^{Note 1}		+/-0.01 mm	+/-0.01 mm	+/-0.004 °	
Maximum speed		4.5 m/sec	1.1 m/sec	1020 °/sec	
Maximum payload		4 kg			
Standard cycle time: with 2kg payload ^{Note 2}		0.50 sec			
R-axis tolerable moment of inertia ^{Note 3}		0.05 kgm ²			
Protection class ^{Note 4}		Equivalent to IP65 (IEC 60529)			
User wiring		0.2 sq x 10 wires			
User tubing (Outer diameter)		φ 4 x 4			
Travel limit		1.Soft limit 2.Mechanical stopper (X,Y,Z axis)			
Robot cable length		Standard: 3.5 m Option: 5 m, 10 m			
Weight		21.5 kg			

- Note 1. This is the value at a constant ambient temperature. (X,Y axes)
 Note 2. When reciprocating 25mm in vertical direction and 300mm in horizontal direction (rough-positioning arch motion).
 Note 3. The acceleration coefficient is set automatically in accordance with the tip weight and R-axis moment of inertia settings.
 Note 4. Do not use robots where the bellows section is directly exposed to water jet. Contact our distributor for information on drip-proof structure preventing liquid other than water.

Controller

Controller	Power capacity (VA)	Operation method
RCX340	1000	Programming / I/O point trace / Remote command / Operation using RS-232C communication

- Note. The movement range can be limited by changing the positions of X and Y axis mechanical stoppers. (The movement range is set to the maximum at the time of shipment.)
 See our robot manuals (installation manuals) for detailed information.
 Note. To set the standard coordinates with high accuracy, use a standard coordinate setting jig (option). Refer to the user's manual (installation manual) for more details.

Our robot manuals (installation manuals) can be downloaded from our website at the address below:
<https://global.yamaha-motor.com/business/robot/>

YK250XGP

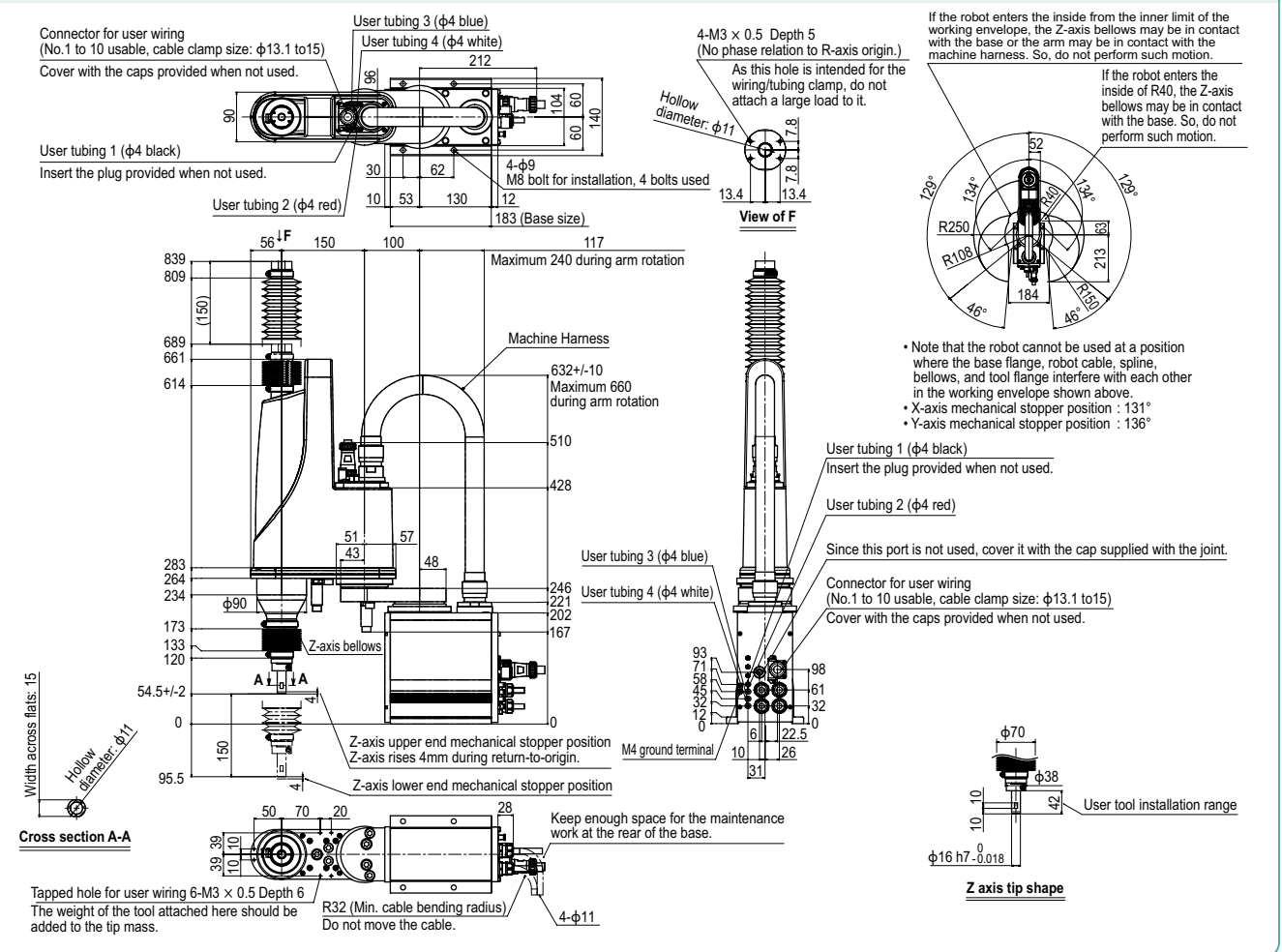

YA	Articulated robots
LCM	Linear conveyor modules
CX	Single-axis robots
Robomity	Motor-less single axis actuator
TRANSERO	Compact single-axis robots
FLIP-X	Single-axis robots
PHASER	Linear motor single-axis robots
XY-X	Cartesian robots
YK-X	SCARA robots
YP-X	Pick & place robots
CLEAN	CLEAN
CONTROLLER	CONTROLLER
INFORMATION	INFORMATION
Orbit/Extra small type	Orbit/Extra small type
Small / Medium type	Small / Medium type
Large type	Large type
Wall mount / Inverse type	Wall mount / Inverse type
Dust-proof & drip-proof type	Dust-proof & drip-proof type

YK250XGP Tool flange mount type

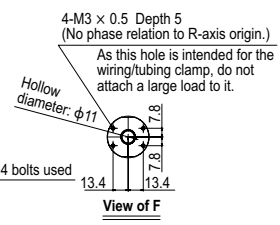
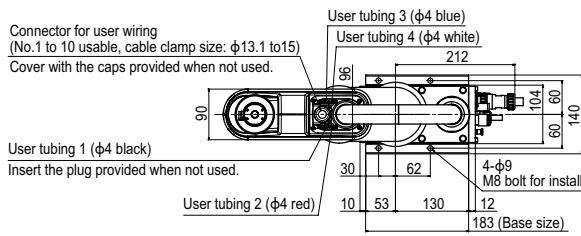

If the robot enters the inside from the inner limit of the working envelope, the Z-axis bellows may be in contact with the base or the arm may be in contact with the machine harness. So, do not perform such motion.

If the robot enters the inside of R40, the Z-axis bellows may be in contact with the base. So, do not perform such motion.

